

New PRO9 and PRO9FXL

Air Cooled Pro-Grip™ TIG Welding Torch

Rating: 125A DC, 100A AC @ 60% Duty Cycle, EN60974-7 .020" to 3/32" 0.5mm-2.4mm Electrodes

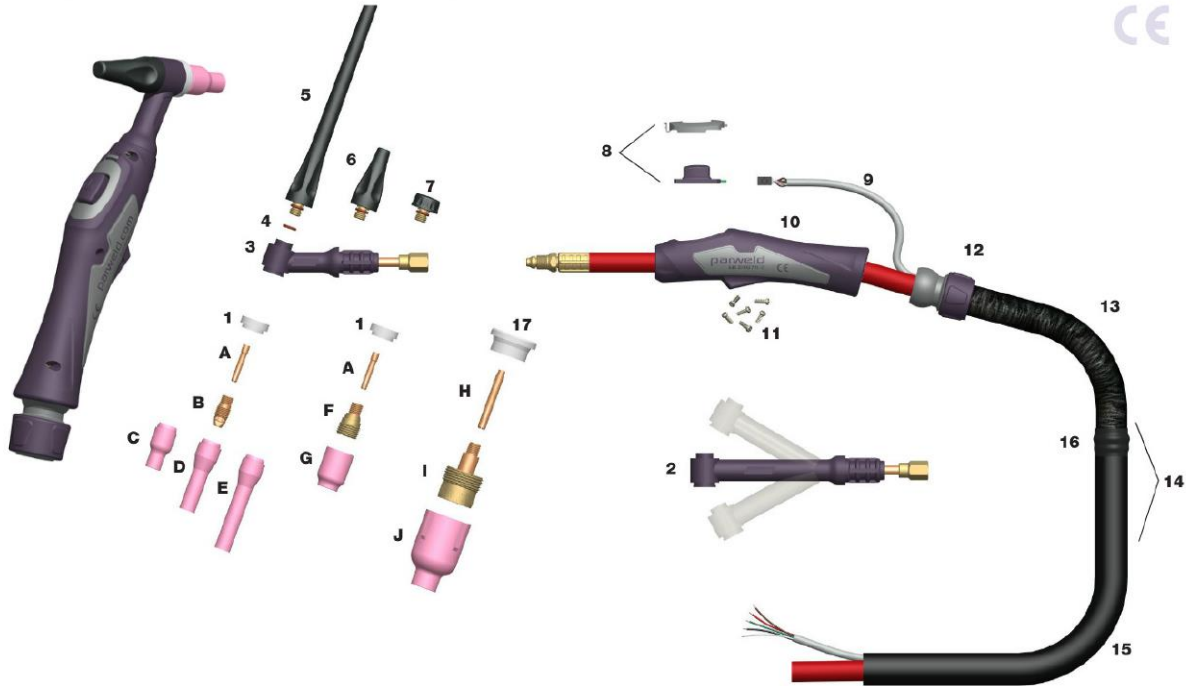

Pro-Grip™

Torch Head		
Stock Code	Description	
PRO9	PRO9	Torch Head Air Cooled 125A DC
PRO9FXL	PRO9FXL	Torch Head Flexible Air Cooled 125A DC

Cable Length		
Stock Code	Description	
12	12.5ft Cables (4m)	c/w Leather Cover and Sheath
25	25ft Cables (8m)	c/w Leather Cover and Sheath

Switch Option	
Stock Code	Description
S1	Momentary Switch
S1L	Momentary Switch and Lever
S2	2 Button Momentary
S3	3 Button Momentary
S4	4 Switch Momentary Rocker Kit
1K	1 Button Momentary +1K Potentiometer
2K	1 Button Momentary +5K Potentiometer
3K	1 Button Momentary +10K Potentiometer
4K	1 Button Momentary +25K Potentiometer
N	Blank

Cable Termination	
UK/European Cable Termination	
Stock Code	Description
BG	Single 3/8" BSP Connection
EG	Central Connector
WG	WTG Connector
LG	L-TEC Euro
BD	35-50 Dinse on Power 3/8" BSP on gas

USA Cable Termination	
Stock Code	Description
US	Lug on power, 5/8" UNF RH Male on Gas
UN	Single 5/8" UNF RH male
UD	35-95 dinse on power, 5/8" UNF RH Male on Gas

Cable Plug	
Stock Code	Description
0	2 Pin Amphenol Plug
1	4 Pin Amphenol Plug
2	5 Pin Amphenol Plug
3	6 Pin Amphenol Plug
4	14 Pin Amphenol Plug
5	6 Pin Harting Plug
6	8 Pin Thermal Arc Plug
7	3 Pin Tuchel Plug
8	9 Pin Tuchel Plug
9	5 Pin Tuchel Plug
10	12 Pin Bundy Plug
11	7 Pin Migatronic Plug
12	2 Pin XTI Inverter Plug
14	5 Pin XTI Inverter Plug

PROLINE

professional welding supplies

Standard Collet

Stock Code Description

A	13N20	Standard Collet .020"/0.5mm Bore
	13N21	Standard Collet .040"/1.0mm Bore
	13N22	Standard Collet 1/16"/1.6mm Bore
	13N22M	Standard Collet 5/64"/2.0mm Bore
	13N23	Standard Collet 3/32"/2.4mm Bore

Standard Collet Body

Stock Code Description

B	13N25	Standard Collet Body .020"/0.5mm Bore
	13N26	Standard Collet Body .040"/1.0mm Bore
	13N27	Standard Collet Body 1/16"/1.6mm Bore
	13N27M	Standard Collet Body 5/64"/2.0mm Bore
	13N28	Standard Collet Body 3/32"/2.4mm Bore

Standard Ceramic Cup

Stock Code Description

C	13N08	Standard Ceramic Cup 1/4"/6mm Bore
	13N09	Standard Ceramic Cup 5/16"/8mm Bore
	13N10	Standard Ceramic Cup 3/8"/10mm Bore
	13N11	Standard Ceramic Cup 7/16"/11mm Bore
	13N12	Standard Ceramic Cup 1/2"/15mm Bore
	13N13	Standard Ceramic Cup 5/8"/16mm Bore

Long Ceramic Cup

Stock Code Description

D	796F70	Long Ceramic Cup 3/16"/5mm Bore
	796F71	Long Ceramic Cup 1/4"/6mm Bore
	796F72	Long Ceramic Cup 5/16"/8mm Bore
	796F73	Long Ceramic Cup 3/8"/10mm Bore

Extra Long Ceramic Cup

Stock Code Description

E	796F74	Extra Long Ceramic Cup 3/16"/5mm Bore
	796F75	Extra Long Ceramic Cup 1/4"/6mm Bore
	796F76	Extra Long Ceramic Cup 5/16"/8mm Bore
	796F77	Extra Long Ceramic Cup 3/8"/10mm Bore

Gas Lens Body

Stock Code Description

F	45V41	Gas Lens Body .020"/0.5mm Bore
	45V42	Gas Lens Body .040"/1.0mm Bore
	45V43	Gas Lens Body 1/16"/1.6mm Bore

Gas Lens Cup

Stock Code Description

G	53N58	Standard Gas Lens Cup 1/4"/6mm Bore
	53N59	Standard Gas Lens Cup 5/16"/6mm Bore
	53N60	Standard Gas Lens Cup 3/8"/8mm Bore
	53N61	Standard Gas Lens Cup 7/16"/10mm Bore
	53N61-S	Standard Gas Lens Cup 1/2"/13mm Bore

Large Diameter Gas Lens Collet

Stock Code Description

H	13N22L	Large Dia Gas Lens Collet 1/16"/1.6mm Bore
	13N23L	Large Dia Gas Lens Collet 3/32"/2.4mm Bore

Large Diameter Gas Lens Body

Stock Code Description

I	45V116S	Large Dia Gas Lens Body 1/16"/1.6mm Bore
	45V64S	Large Dia Gas Lens Body 3/32"/2.4mm Bore

Large Diameter Gas Lens Cup

Stock Code Description

J	57N75	Large Dia Gas Lens Cup 3/8"/10mm Bore
	57N74	Large Dia Gas Lens Cup 1/2"/13mm Bore
	53N88	Large Dia Gas Lens Cup 5/8"/16mm Bore
	53N87	Large Dia Gas Lens Cup 3/4"/19mm Bore

Components

Stock Code Description

1	598882	Cup Gasket
2	PRO9FXL	Torch Head Flexible
3	PRO9	Torch Head including Cup Gasket
4	98W77	Back Cap O Ring
5	PRO41V24	Pro-Grip™ Tig Back Cap Long
6	PRO41V35	Pro-Grip™ Tig Back Cap Medium
7	PRO41V33	Pro-Grip™ Tig Back Cap Small
8	PRO1MS	Momentary Switch Kit (fitted as Standard) Alternative switch options are listed on Page 137
9	PROSWL4	Switch & Leads x 4mt/12.5ft
	PROSWL8	Switch & Leads x 8mt/25ft
10	PROH100	Pro-Grip™ Tig Handle Small
11	PROSP	Screw Pack
12	PROKJ100	Knuckle Joint c/w Lock Nut
13	PROLC100-08	Leather Cover x 0.8mt/2.6ft
14	PROCO100-40	Complete Cover Assembly x 4mt/12.5ft
	PROCO100-80	Complete Cover Assembly x 8mt/25ft
15	PRONC32	Neoprene Cover x 3.2mt/10.5ft
	PRONC72	Neoprene Cover x 7.2mt/23.6ft
16	PROJK100	Jointing Repair Kit
17	54N63-20	Insulator Large Diameter Gas Lens

Ph: 0800 699 353

sales@prolinewelding.com

New PRO20 and PRO20FXL

Water Cooled Pro-Grip™ Tig Welding Torch

Rating: 250A DC, 190A AC @ 100% Duty Cycle, EN60974-7 .020" to 1/8"/0.5mm-3.2mm Electrodes

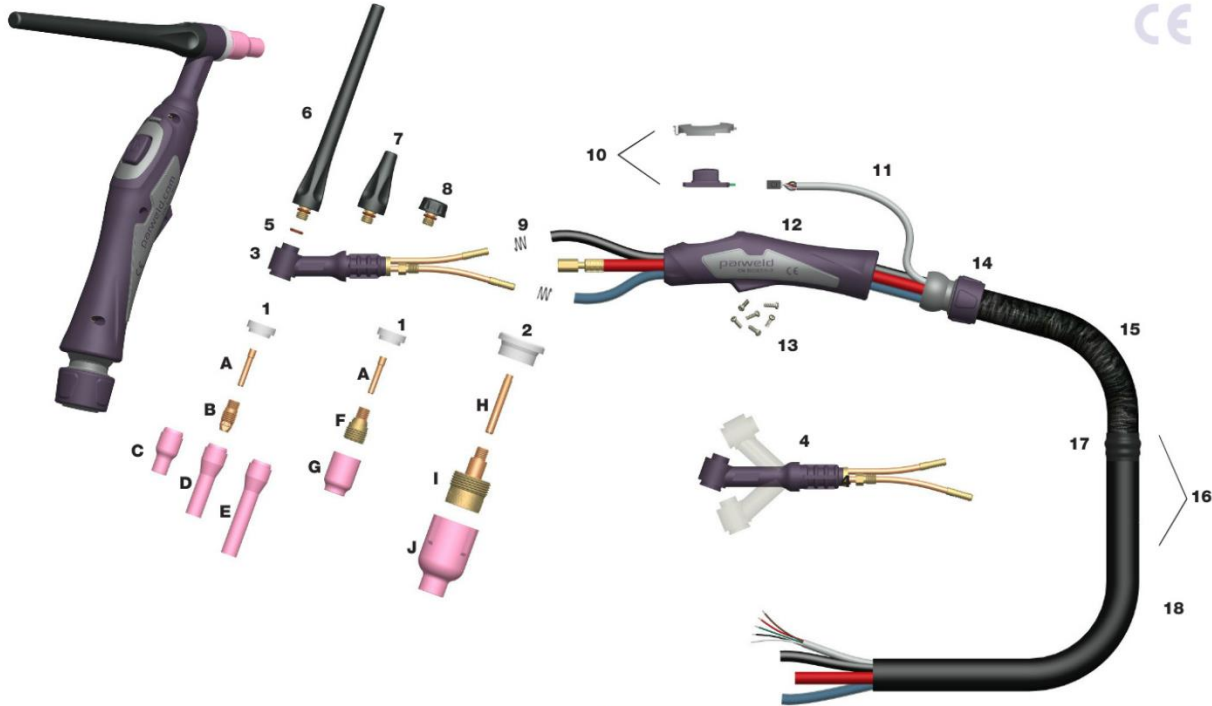

Torch Head

Stock Code Description

PRO20	Torch Head Water Cooled 250A DC
PRO20FXL	Torch Head Flexible Water Cooled 250A DC

Cable Length

Stock Code Description

12	12.5ft Cables (4m) c/w Leather Cover and Neoprene Sheath
25	25ft Cables (8m) c/w Leather Cover and Neoprene Sheath

Switch Option

Stock Code Description

S1	Momentary Switch
S1L	Momentary Switch and Lever
S2	2 Button Momentary
S3	3 Button Momentary
S4	4 Switch Momentary Rocker Kit
1K	1 Button Momentary +1K Potentiometer
2K	1 Button Momentary +5K Potentiometer
3K	1 Button Momentary +10K Potentiometer
4K	1 Button Momentary +25K Potentiometer
N	Blank

Cable Termination

UK/European Cable Termination

Stock Code Description

BW	3/8" BSP On Water, Gas, Power
DQ	35-95 Dinse, Quick fit Water In/Out, 3/8" BSP Gas
EW	Central Connector
WW	WTW Connector
LW	L-TEC Euro

USA Cable Termination

Stock Code Description

UW	7/8" UNF LH male on power, 5/8" UNF RH male on gas, 5/8" UNF LH male on water
UE	35-95 Dinse on power, 5/8" UNF LH on water In/Out, 5/8" UNF RH male on gas

Cable Plug

Stock Code Description

0	2 Pin Amphenol Plug
1	4 Pin Amphenol Plug
2	5 Pin Amphenol Plug
3	6 Pin Amphenol Plug
4	14 Pin Amphenol Plug
5	6 Pin Harting Plug
6	8 Pin Thermal Arc Plug
7	3 Pin Tuchel Plug
8	9 Pin Tuchel Plug
9	5 Pin Tuchel Plug
10	12 Pin Bundy Plug
11	7 Pin Migatron Plug
12	2 Pin XTI Inverter Plug
14	5 Pin XTI Inverter Plug

For the complete range of Cable Terminations and Plugs please refer to Page 179-187

PROLINE

professional welding supplies

Standard Collet		
Stock Code	Description	
A 13N20	Standard Collet .020"/0.5mm Bore	
13N21	Standard Collet .040"/1.0mm Bore	
13N22	Standard Collet 1/16"/1.6mm Bore	
13N22M	Standard Collet 5/64"/2.0mm Bore	
13N23	Standard Collet 3/32"/2.4mm Bore	
13N24	Standard Collet 1/8"/3.2mm Bore	

Standard Collet Body		
Stock Code	Description	
B 13N25	Standard Collet Body .020"/0.5mm Bore	
13N26	Standard Collet Body .040"/1.0mm Bore	
13N27	Standard Collet Body 1/16"/1.6mm Bore	
13N27M	Standard Collet Body 5/64"/2.0mm Bore	
13N28	Standard Collet Body 3/32"/2.4mm Bore	
13N29	Standard Collet Body 1/8"/3.2mm Bore	

Standard Ceramic Cup		
Stock Code	Description	
C 13N08	Standard Ceramic Cup 1/4"/6mm Bore	
13N09	Standard Ceramic Cup 5/16"/8mm Bore	
13N10	Standard Ceramic Cup 3/8"/10mm Bore	
13N11	Standard Ceramic Cup 7/16"/11mm Bore	
13N12	Standard Ceramic Cup 1/2"/13mm Bore	
13N13	Standard Ceramic Cup 5/8"/16mm Bore	

Long Ceramic Cup		
Stock Code	Description	
D 796F70	Long Ceramic Cup 3/16"/5mm Bore	
796F71	Long Ceramic Cup 1/4"/6mm Bore	
796F72	Long Ceramic Cup 5/16"/8mm Bore	
796F73	Long Ceramic Cup 3/8"/10mm Bore	

Extra Long Ceramic Cup		
Stock Code	Description	
E 796F74	Extra Long Ceramic Cup 3/16"/5mm Bore	
796F75	Extra Long Ceramic Cup 1/4"/6mm Bore	
796F76	Extra Long Ceramic Cup 5/16"/8mm Bore	
796F77	Extra Long Ceramic Cup 3/8"/10mm Bore	

Gas Lens Body		
Stock Code	Description	
F 45V41	Gas Lens Body .020"/0.5mm Bore	
45V42	Gas Lens Body .040"/1.0mm Bore	
45V43	Gas Lens Body 1/16"/1.6mm Bore	
45V44	Gas Lens Body 3/32"/2.4mm Bore	
45V45	Gas Lens Body 1/8"/3.2mm Bore	

Gas Lens Cup		
Stock Code	Description	
G 53N58	Standard Gas Lens Cup 1/4"/6mm Bore	
53N59	Standard Gas Lens Cup 5/16"/8mm Bore	
53N60	Standard Gas Lens Cup 3/8"/10mm Bore	
53N61	Standard Gas Lens Cup 7/16"/11mm Bore	
53N61-S	Standard Gas Lens Cup 1/2"/13 mm Bore	

Large Diameter Gas Lens Collet		
Stock Code	Description	
H 13N22L	Large Diameter Gas Lens Collet 1/16"/1.6mm Bore	
13N23L	Large Diameter Gas Lens Collet 3/32"/2.4mm Bore	

Large Diameter Gas Lens Body		
Stock Code	Description	
I 45V116S	Large Diameter Gas Lens Body 1/16"/1.6mm Bore	
45V64S	Large Diameter Gas Lens Body 3/32"/2.4mm Bore	

Large Diameter Gas Lens Cup		
Stock Code	Description	
J 57N75	Large Diameter Gas Lens Cup 3/8"/10mm Bore	
57N74	Large Diameter Gas Lens Cup 1/2"/11mm Bore	
53N88	Large Diameter Gas Lens Cup 5/8"/16mm Bore	
53N87	Large Diameter Gas Lens Cup 3/4"/19mm Bore	

Components		
Stock Code	Description	
1 598882	Cup Gasket	
2 54N63-20	Insulator Large Diameter Gas Lens	
3 PRO20	Torch Head including Cup Gasket	
4 PRO20FXL	Torch Head Flexible	
5 98W77	Back Cap O Ring	
6 PRO41V24	Pro-Grip™ Tig Back Cap Long	
7 PRO41V35	Pro-Grip™ Tig Back Cap Medium	
8 PRO41V33	Pro-Grip™ Tig Back Cap Small	
9 53N04	Wire Clamps	
10 PRO1MS	Momentary Switch Kit (fitted as Standard) Alternative switch options are listed on Page 137	
11 PROSWL4	Connector Leads x 4mt/12.5ft	
PROSWL8	Connector Leads x 8mt/25ft	
12 PROH100	Pro-Grip™ Tig Handle Small	
13 PROSP	Screw Pack	
14 PROKJ100	Knuckle Joint c/w Lock Nut	
15 PROLC100-08	Leather Cover x 0.8mt/2.6ft	
16 PROCO100-40	Complete Cover Assembly 4mt/12.5ft	
PROCO100-80	Complete Cover Assembly x 8mt/25ft	
17 PROJK100	Jointing Repair Kit	
18 PRONC-32	Neoprene Cover x 3.2mt/10.5ft	
PRONC-72	Neoprene Cover x 7.2mt/23.6ft	

Pro-Grip™

New PRO17 and PRO17FX

Air Cooled Pro-Grip™ Tig Welding Torch

Rating: 150A DC, 115A AC @ 60% Duty Cycle, EN60974-7 0.040" to 1/8"/0.5mm-3.2mm Electrodes

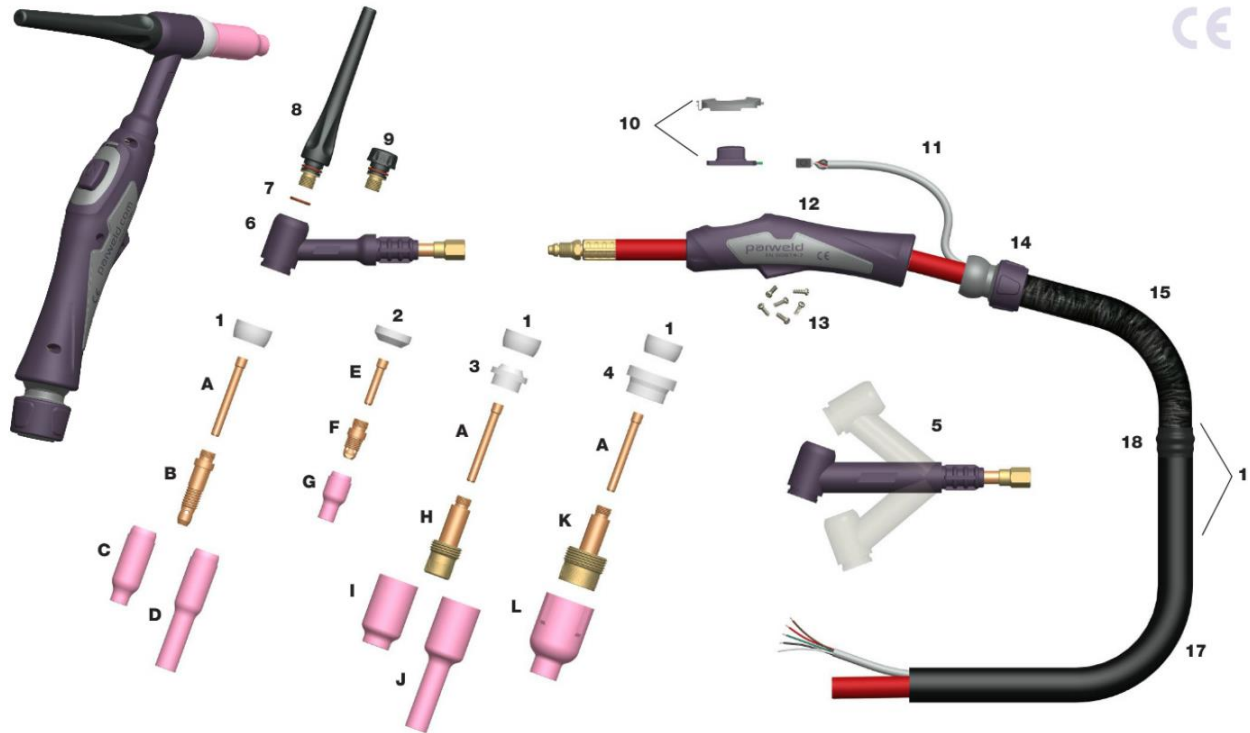

Torch Head

Stock Code Description

PHO17	PHO17	Torch Head Air Cooled 150A DC
PRO17FX	PRO17FX	Torch Head Flexible Air Cooled 150A DC

Cable Length

Stock Code Description

12	12.5ft Cables (4m)	c/w Leather Cover and Neoprene Sheath
25	25ft Cables (8m)	c/w Leather Cover and Neoprene Sheath

Switch Option

Stock Code Description

S1	Momentary Switch
S1L	Momentary Switch and Lever
S2	2 Button Momentary
S3	3 Button Momentary
S4	4 Switch Momentary Rocker Kit
1K	1 Button Momentary +1K Potentiometer
2K	1 Button Momentary +5K Potentiometer
3K	1 Button Momentary +10K Potentiometer
4K	1 Button Momentary +25K Potentiometer
N	Blank

Cable Termination

UK/European Cable Termination Stock Code Description

BG	Single 3/8" BSP Connection
EG	Central Connector
WG	WTG Connector
LG	L-TEC Euro
BD	35-50 Dinse on Power 3/8" BSP on gas

USA Cable Termination Stock Code Description

US	Lug on power, 5/8" UNF RH Male on Gas
UN	Single 5/8" UNF RH male
UD	35-95 dinse on power, 5/8" UNF RH Male on Gas

Cable Plug

Stock Code Description

0	2 Pin Amphenol Plug
1	4 Pin Amphenol Plug
2	5 Pin Amphenol Plug
3	6 Pin Amphenol Plug
4	14 Pin Amphenol Plug
5	6 Pin Harting Plug
6	8 Pin Thermal Arc Plug
7	3 Pin Tuchel Plug
8	9 Pin Tuchel Plug
9	5 Pin Tuchel Plug
10	12 Pin Bundy Plug
11	7 Pin Migatronic Plug
12	2 Pin XTI Inverter Plug
14	5 Pin XTI Inverter Plug

For the complete range of Cable Terminations and Plugs please refer to Page 179-187

PROLINE

professional welding supplies

Standard Collet		
Stock Code	Description	
A 10N21	Standard Collet 0.020"/0.5mm Bore	
10N22	Standard Collet 0.040"/1.0mm Bore	
10N23	Standard Collet 1/16"/1.6mm Bore	
10N23M	Standard Collet 5/64"/2.0mm Bore	
10N24	Standard Collet 3/32"/2.4mm Bore	
10N25	Standard Collet 1/8"/3.2mm Bore	
54N20	Standard Collet 5/32"/4.0mm Bore	

Standard Collet Body		
Stock Code	Description	
B 10N29	Standard Collet Body .020"/0.5mm Bore	
10N30	Standard Collet Body .040"/1.0mm Bore	
10N31	Standard Collet Body 1/16"/1.6mm Bore	
10N32	Standard Collet Body 3/32"/2.4mm Bore	
10N28	Standard Collet Body 1/8"/3.2mm Bore	
406488	Standard Collet Body 5/32"/4.0mm Bore	

Standard Ceramic Cup		
Stock Code	Description	
C 10N50	Standard Ceramic Cup 1/4"/6mm Bore	
10N49	Standard Ceramic Cup 5/16"/8mm Bore	
10N48	Standard Ceramic Cup 3/8"/10mm Bore	
10N47	Standard Ceramic Cup 7/16"/11mm Bore	
10N46	Standard Ceramic Cup 1/2"/13mm Bore	
10N45	Standard Ceramic Cup 5/8"/16mm Bore	
10N44	Standard Ceramic Cup 3/4"/19mm Bore	

Standard Long Ceramic Cup		
Stock Code	Description	
D 10N49L	Long Ceramic Cup 5/16"/8mm Bore	
10N48L	Long Ceramic Cup 3/8"/10mm Bore	
10N47L	Long Ceramic Cup 7/16"/11mm Bore	

Stubby Series Collet		
Stock Code	Description	
E 10N21S	Stubby Collet .020"/0.5mm Bore	
10N22S	Stubby Collet .040"/1.0mm Bore	
10N23S	Stubby Collet 1/16"/1.6mm Bore	
10N24S	Stubby Collet 3/32"/2.4mm Bore	
10N25S	Stubby Collet 1/8"/3.2mm Bore	

Stubby Collet Body		
Stock Code	Description	
F 17CB20	Stubby Collet Body .020"-1.8"mm/0.5mm-3.2mm Bore	

Stubby Series Ceramic Cup		
Stock Code	Description	
G 13N08	Standard Ceramic Cup 1/4"/6mm Bore	
13N09	Standard Ceramic Cup 5/16"/8mm Bore	
13N10	Standard Ceramic Cup 3/8"/10mm Bore	
13N11	Standard Ceramic Cup 7/16"/11mm Bore	
13N12	Standard Ceramic Cup 1/2"/13mm Bore	
13N13	Standard Ceramic Cup 5/8"/16mm Bore	

Gas Lens Body		
Stock Code	Description	
H 45V24	Gas Lens Body .040"/1.0mm Bore	
45V25	Gas Lens Body 1/16"/1.6mm Bore	

Gas Lens Body – continued		
Stock Code	Description	
45V26	Gas Lens Body 3/32"/2.4mm Bore	
45V27	Gas Lens Body 1/8"/3.2mm Bore	
45V28	Gas Lens Body 5/32"/4.0mm Bore	

Standard Gas Lens Cup		
Stock Code	Description	
I 54N18	Standard Gas Lens Cup 1/4"/6mm Bore	
54N17	Standard Gas Lens Cup 5/16"/8mm Bore	
54N16	Standard Gas Lens Cup 3/8"/10mm Bore	
54N15	Standard Gas Lens Cup 7/16"/11mm Bore	
54N14	Standard Gas Lens Cup 1/2"/13mm Bore	
54N19	Standard Gas Lens Cup 11/16"/17mm Bore	

Long Gas Lens Cup		
Stock Code	Description	
J 54N17L	Long Gas Lens Cup 5/16"/8mm Bore	
54N16L	Long Gas Lens Cup 3/8"/10mm Bore	
54N15L	Long Gas Lens Cup 7/16"/11mm Bore	

Large Diameter Gas Lens Body		
Stock Code	Description	
K 45V116	Large Dia Gas Lens Body 1/16"/1.6mm Bore	
45V64	Large Dia Gas Lens Body 3/32"/2.4mm Bore	
45V63	Large Dia Gas Lens Body 5/32"/4.0mm Bore	
995795	Large Dia Gas Lens Body 1/8"/3.2mm Bore	

Large Diameter Gas Lens Cup		
Stock Code	Description	
L 57N75	Large Dia Gas Lens Cup 3/8"/10mm Bore	
57N74	Large Dia Gas Lens Cup 1/2"/13mm Bore	
53N88	Large Dia Gas Lens Cup 5/8"/16mm Bore	
53N87	Large Dia Gas Lens Cup 3/4"/19mm Bore	

Components		
Stock Code	Description	
1 18CG	Cup Gasket	
2 18CG20	Cup Gasket for Stubby Collet Body	
3 54N01	Gas Lens Insulator (use with 18CG)	
4 54N63	Insulator Large Diameter Gas Lens (use with 18CG)	
5 PRO17FX	Torch Head Flexible	
6 PRO17	Torch Head including Cip Gasket	
7 98W18	Back Cap O Ring	
8 PRO57Y02	Back Cap Long	
9 PRO57Y04	Back Cap Short	
10 PRO1MS	Momentary Switch Kit (fitted as Standard) Alternative switch options are listed on Page 137	
11 PROSWL4	Connector & Leads x 4mt/12.5ft	
PROSWL8	Connector & Leads x 8mt/25ft	
12 PROH100	Pro-Grip™ Tig Handle Small	
13 PROSP	Screw Pack	
14 PROKJ100	Knuckle Joint c/w Lock Nut	
15 PROLC100-08	Leather Cover x 0.8mt/2.6ft	
16 PROCO100-40	Complete Cover Assembly x 4mt/12.5ft	
PROCO100-80	Complete Cover Assembly x 8mt/25ft	
17 PRONC32	Neoprene Cover x 3.2mt/10.5ft	
PRONC72	Neoprene Cover x 7.2mt/23.6ft	
18 PROJK100	Sheath Jointing Repair Kit	

New PRO18 and PRO18FX

Water Cooled Pro-Grip™ Tig Welding Torch

Rating: 350A DC, 260A AC @ 100% Duty Cycle, EN60974-7 0.020" to 5/32"/0.5mm-4.0mm Electrodes

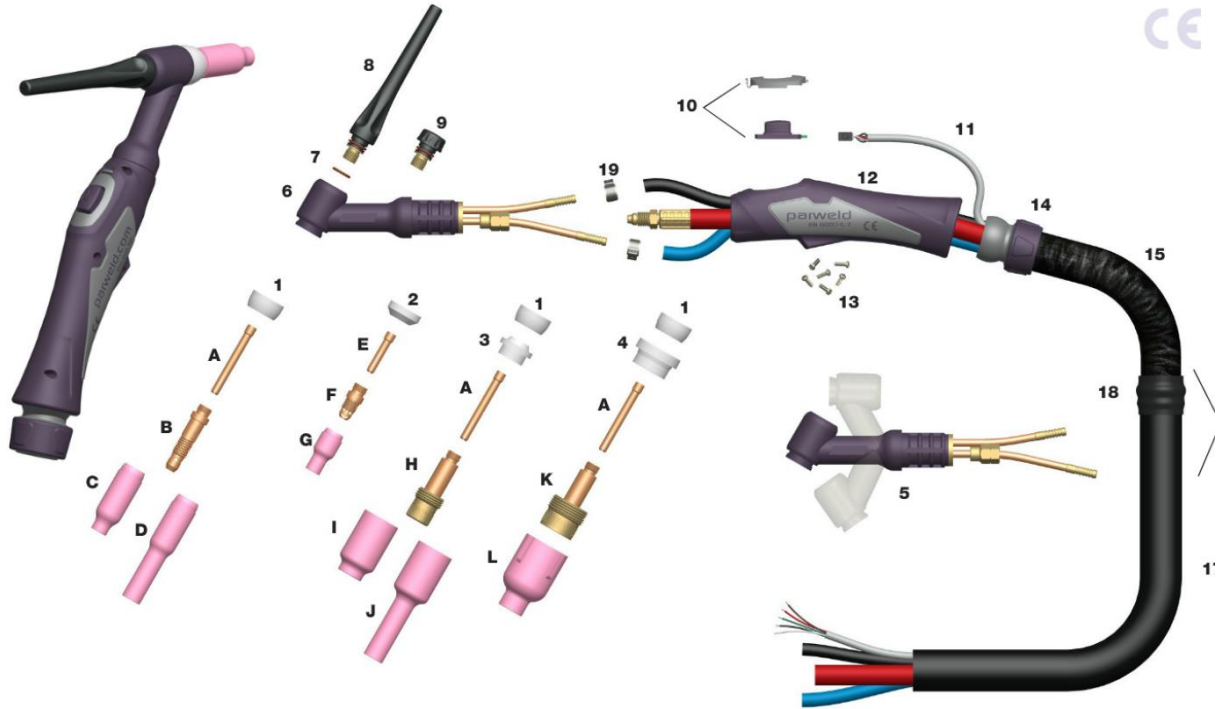

Torch Head

Stock Code	Description
PRO18	PRO18 Torch Head Water Cooled 350A DC
PRO18FX	PRO18FX Torch Head Flexible Water Cooled 350A DC

Cable Length

Stock Code	Description
12	12.5ft Cables (4m) c/w Leather Cover and Neoprene Sheath
25	25ft Cables (8m) c/w Leather Cover and Neoprene Sheath

Switch Option

Stock Code	Description
S1	Momentary Switch
S1L	Momentary Switch and Lever
S2	2 Button Momentary
S3	3 Button Momentary
S4	4 Switch Momentary Rocker Kit
1K	1 Button Momentary +1K Potentiometer
2K	1 Button Momentary +5K Potentiometer
3K	1 Button Momentary +10K Potentiometer
4K	1 Button Momentary +25K Potentiometer
N	Blank

For the complete range of Cable Terminations and Plugs please refer to Page 179-187

Cable Termination

UK/European Cable Termination

Stock Code	Description
BW	3/8" BSP On Water, Gas, Power
EW	Central Connector
WW	WTW Connector
LW	L-TEC Euro
DQ	35-50 Dinse on Power QF on Water, In/Out 3/8" BSP on gas

USA Cable Termination

Stock Code	Description
UW	7/8" UNF LH male on power, 5/8" UNF RH male on gas, 5/8" UNF LH male on water
UE	35-95 Dinse on power, 5/8" UNF LH on water In/Out, 5/8" UNF RH male on gas

Cable Plug

Stock Code	Description
0	2 Pin Amphenol Plug
1	4 Pin Amphenol Plug
2	5 Pin Amphenol Plug
3	6 Pin Amphenol Plug
4	14 Pin Amphenol Plug
5	6 Pin Harting Plug
6	8 Pin Thermal Arc Plug
7	3 Pin Tuchel Plug
8	9 Pin Tuchel Plug
9	5 Pin Tuchel Plug
10	12 Pin Bundy Plug
11	7 Pin Migatronic Plug
12	2 Pin XTI Inverter Plug
14	5 Pin XTI Inverter Plug

PROLINE

professional welding supplies

Standard Collet		
Stock Code	Description	
A 10N21	Standard Collet .020"/0.5mm Bore	
10N22	Standard Collet .040"/1.0mm Bore	
10N23	Standard Collet 1/16"/1.6mm Bore	
10N23M	Standard Collet 5/64"/2.0mm Bore	
10N24	Standard Collet 3/32"/2.4mm Bore	
10N25	Standard Collet 1/8"/3.2mm Bore	
54N20	Standard Collet 5/32"/4.0mm Bore	

Standard Collet Body		
Stock Code	Description	
B 10N29	Standard Collet Body .020"/0.5mm Bore	
10N30	Standard Collet Body .040"/1.0mm Bore	
10N31	Standard Collet Body 1/16"/1.6mm Bore	
10N31M	Standard Collet Body 5/64"/2.0mm Bore	
10N32	Standard Collet Body 3/32"/2.4mm Bore	
10N28	Standard Collet Body 1/8"/3.2mm Bore	
406488	Standard Collet Body 5/32"/4.0mm Bore	

Standard Ceramic Cup		
Stock Code	Description	
C 10N50	Standard Ceramic Cup 1/4"/6mm Bore	
10N49	Standard Ceramic Cup 5/16"/8mm Bore	
10N48	Standard Ceramic Cup 3/8"/10mm Bore	
10N47	Standard Ceramic Cup 7/16"/11mm Bore	
10N46	Standard Ceramic Cup 1/2"/13mm Bore	
10N45	Standard Ceramic Cup 5/8"/16mm Bore	
10N44	Standard Ceramic Cup 3/4"/19mm Bore	

Long Ceramic Cup		
Stock Code	Description	
D 10N49L	Long Ceramic Cup 5/16"/8mm Bore	
10N48L	Long Ceramic Cup 3/8"/10mm Bore	
10N47L	Long Ceramic Cup 7/16"/11mm Bore	

Stubby Collet		
Stock Code	Description	
E 10N21S	Stubby Collet .020"/0.5mm Bore	
10N22S	Stubby Collet .040"/1.0mm Bore	
10N23S	Stubby Collet 1/16"/1.6mm Bore	
10N24S	Stubby Collet 3/32"/2.4mm Bore	
10N25S	Stubby Collet 1/8"/3.2mm Bore	

Stubby Collet Body		
Stock Code	Description	
F 17CB20	Stubby Collet Body .020"-1/8"/0.5mm-3.2mm Bore	

Stubby Standard Ceramic Cup		
Stock Code	Description	
G 13N08	Standard Ceramic Cup 1/4"/6mm Bore	
13N09	Standard Ceramic Cup 5/16"/8mm Bore	
13N10	Standard Ceramic Cup 3/8"/10mm Bore	
13N11	Standard Ceramic Cup 7/16"/11mm Bore	
13N12	Standard Ceramic Cup 1/2"/13mm Bore	
13N13	Standard Ceramic Cup 5/8"/16mm Bore	

Gas Lens Body		
Stock Code	Description	
H 45V24	Gas Lens Body .040"/1.0mm Bore	
45V25	Gas Lens Body 1/16"/1.6mm Bore	

Gas Lens Body – continued		
Stock Code	Description	
45V26	Gas Lens Body 3/32"/2.4mm Bore	
45V27	Gas Lens Body 1/8"/3.2mm Bore	
45V28	Gas Lens Body 5/32"/4.0mm Bore	

Standard Gas Lens Cup		
Stock Code	Description	
I 54N18	Standard Gas Lens Cup 1/4"/6mm Bore	
54N17	Standard Gas Lens Cup 5/16"/8mm Bore	
54N16	Standard Gas Lens Cup 3/8"/10mm Bore	
54N15	Standard Gas Lens Cup 7/16"/11mm Bore	
54N14	Standard Gas Lens Cup 1/2"/13mm Bore	
54N19	Standard Gas Lens Cup 1/16"/17mm Bore	

Long Gas Lens Cup		
Stock Code	Description	
J 54N17L	Long Gas Lens Cup 5/16"/8mm Bore	
54N16L	Long Gas Lens Cup 3/8"/10mm Bore	
54N15L	Long Gas Lens Cup 7/16"/11mm Bore	

Large Diameter Gas Lens Body		
Stock Code	Description	
K 45V116	Large Dia Gas Lens Bdy 1/16"/1.6mm Bore	
45V64	Large Dia Gas Lens Body 3/32"/2.4mm Bore	
995795	Large Dia Gas Lens Body 1/8"/3.2mm Bore	

Large Diameter Gas Lens Cup		
Stock Code	Description	
L 57N75	Large Dia Gas Lens Cup 3/8"/10mm Bore	
57N74	Large Dia Gas Lens Cup 1/2"/13mm Bore	
53N88	Large Dia Gas Lens Cup 5/8"/16mm Bore	
53N87	Large Dia Gas Lens Cup 3/4"/19mm Bore	

Components		
Stock Code	Description	
1	18CG	Cup Gasket
2	18CG20	Cup Gasket for Stubby Collet Body
3	54N01	Gas Lens Insulator (use with 18CG)
4	54N63	Insulator Large Diameter Gas Lens (use with 18CG)
5	PRO18FX	Torch Head Flexible
6	PRO18	Torch Head including Cup Gasket
7	98W18	Back Cap O Ring
8	PRO57Y02	Back Cap Long
9	PRO57Y04	Back Cap Short
10	PRO1MS	Momentary Switch Kit (fitted as Standard) Alternative switch options are listed on Page 137
11	PROSWL4	Connector Leads x 4mt/12.5ft
	PROSWL8	Connector Leads x 8mt/25ft
12	PROH200	Pro-Grip™ Tig Handle Large
13	PROSP	Screw Pack
14	PROKJ200	Knuckle Joint c/w Lock Nut
15	PROLC200-08	Leather Cover x 0.8mt/2.6ft
16	PROCO200-40	Complete Cover Assembly x 4mt/12.5ft
	PROCO200-80	Complete Cover Assembly x 8mt/25ft
17	PRONC-32	Neoprene Cover x 3.2mt/10.5ft
	PRONC-72	Neoprene Cover x 7.2mt/23.6ft
18	PROJK200	Sheath Jointing Repair Kit
19	B5024	Hose Clamp 9.5mm

New PRO26 and PRO26FX

Air Cooled Pro-Grip™ Tig Welding Torch

Rating: 200A DC, 150A AC @ 60% Duty Cycle, EN60974-7 .020" to 5/32"/0.5mm-4.0mm Electrodes

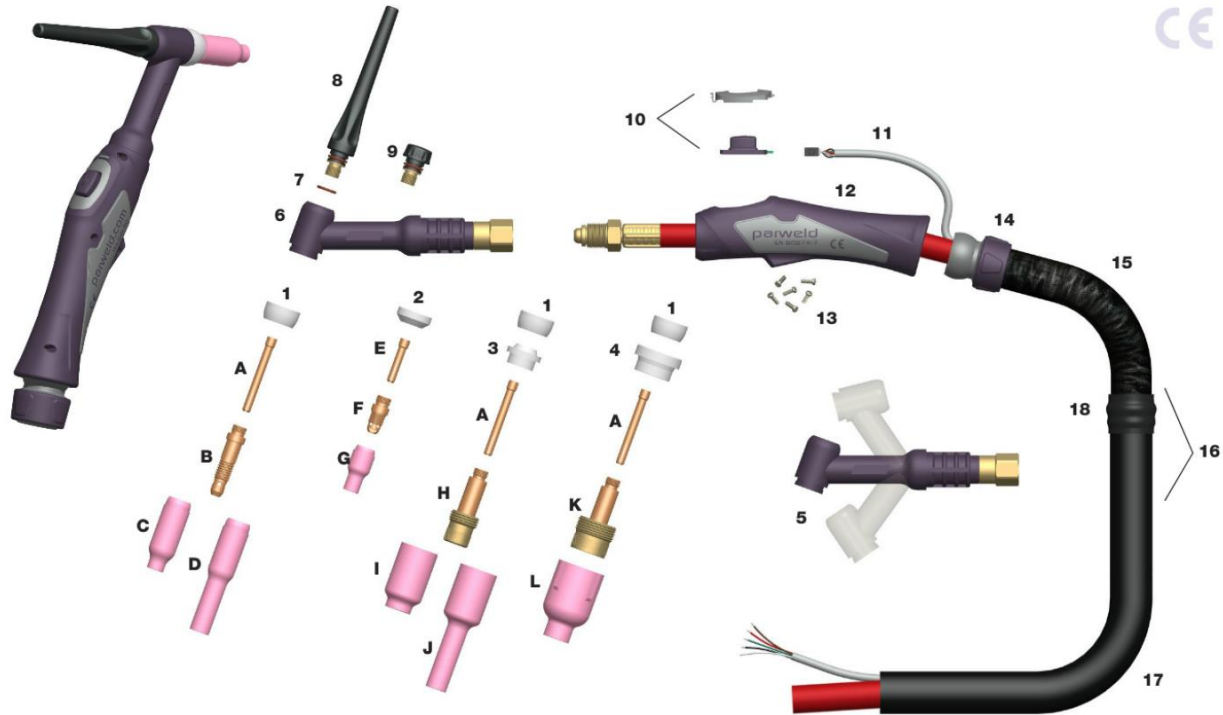

Torch Head

Stock Code	Description
PRO26	Torch Head Air Cooled 200A DC
PRO26FX	Torch Head Flexible Air Cooled 200A DC

Cable Length

Stock Code	Description
12	12.5ft cables (4m) c/wLeather Cover and Neoprene Sheath
25	25ft cables (8m) c/w Leather Cover and Neoprene Sheath

Switch Option

Stock Code	Description
S1	Momentary Switch
S1L	Momentary Switch and Lever
S2	2 Button Momentary
S3	3 Button Momentary
S4	4 Switch Momentary Rocker Kit
1K	1 Button Momentary +1K Potentiometer
2K	1 Button Momentary +5K Potentiometer
3K	1 Button Momentary +10K Potentiometer
4K	1 Button Momentary +25K Potentiometer
N	Blank

Cable Termination

UK/European Cable Termination	
Stock Code	Description
BG	Single 3/8" BSP Connection
EG	Central Connector
WG	WTG Connector
LG	L-TEC Euro
BD	35-50 Dinse on Power 3/8" BSP on gas

USA Cable Termination

Stock Code	Description
US	Lug on power, 5/8" UNF RH Male on Gas
UN	Single 5/8" UNF RH male
UD	35-95 dinse on power, 5/8" UNF RH Male on Gas

Cable Plug

Stock Code	Description
0	2 Pin Amphenol Plug
1	4 Pin Amphenol Plug
2	5 Pin Amphenol Plug
3	6 Pin Amphenol Plug
4	14 Pin Amphenol Plug
5	6 Pin Harting Plug
6	8 Pin Thermal Arc Plug
7	3 Pin Tuchel Plug
8	9 Pin Tuchel Plug
9	5 Pin Tuchel Plug
10	12 Pin Bundy Plug
11	7 Pin Migatronic Plug
12	2 Pin XTI Inverter Plug
14	5 Pin XTI Inverter Plug

For the complete range of Cable Terminations and Plugs please refer to Page 179-187

PROLINE

professional welding supplies

Standard Collet

Stock Code Description

A	10N21	Standard Collet .020"/0.5mm Bore
	10N22	Standard Collet .040"/1.0mm Bore
	10N23	Standard Collet 1/16"/1.6mm Bore
	10N24	Standard Collet 3/32"/2.4mm Bore
	10N25	Standard Collet 1/8"/3.2mm Bore
	54N20	Standard Collet 5/32"/4.0mm Bore

Standard Collet Body

Stock Code Description

B	10N29	Standard Collet Body .020"/0.5mm Bore
	10N30	Standard Collet Body .040"/1.0mm Bore
	10N31	Standard Collet Body 1/16"/1.6mm Bore
	10N32	Standard Collet Body 3/32"/2.4mm Bore
	10N28	Standard Collet Body 1/8"/3.2mm Bore
	406488	Standard Collet Body 5/32"/4.0mm Bore

Standard Ceramic Cup

Stock Code Description

C	10N50	Standard Ceramic Cup 1/4"/6mm Bore
	10N49	Standard Ceramic Cup 5/16"/8mm Bore
	10N48	Standard Ceramic Cup 3/8"/10mm Bore
	10N47	Standard Ceramic Cup 7/16"/11mm Bore
	10N46	Standard Ceramic Cup 1/2"/13mm Bore
	10N45	Standard Ceramic Cup 5/8"/16mm Bore
	10N44	Standard Ceramic Cup 3/4"/19mm Bore

Standard Long Ceramic Cup

Stock Code Description

D	10N49L	Long Ceramic Cup 5/16"/8mm Bore
	10N48L	Long Ceramic Cup 3/8"/10mm Bore
	10N47L	Long Ceramic Cup 7/16"/11mm Bore

Stubby Series Collet

Stock Code Description

E	10N21S	Stubby Collet .020"/0.5mm Bore
	10N22S	Stubby Collet .040"/1.0mm Bore
	10N23S	Stubby Collet 1/16"/1.6mm Bore
	10N24S	Stubby Collet 3/32"/2.4mm Bore
	10N25S	Stubby Collet 1/8"/3.2mm Bore

Stubby Collet Body

Stock Code Description

F	17CB20	Stubby Collet Body .020"-1/8"/0.5mm-3.2mm Bore
----------	--------	--

Stubby Standard Ceramic Cup

Stock Code Description

G	13N08	Standard Ceramic Cup 1/4"/6mm Bore
	13N09	Standard Ceramic Cup 5/16"/8mm Bore
	13N10	Standard Ceramic Cup 3/8"/10mm Bore
	13N11	Standard Ceramic Cup 7/16"/11mm Bore
	13N12	Standard Ceramic Cup 1/2"/13mm Bore
	13N13	Standard Ceramic Cup 5/8"/16mm Bore

Gas Lens Body

Stock Code Description

H	45V29	Gas Lens Body .020"/0.5mm Bore
	45V24	Gas Lens Body .040"/1.0mm Bore
	45V25	Gas Lens Body 1/16"/1.6mm Bore
	45V26	Gas Lens Body 3/32"/2.4mm Bore
	45V27	Gas Lens Body 1/8"/3.2mm Bore

Standard Gas Lens Cup

Stock Code Description

I	54N18	Standard Gas Lens Cup 1/4"/6mm Bore
	54N17	Standard Gas Lens Cup 5/16"/8mm Bore
	54N16	Standard Gas Lens Cup 3/8"/10mm Bore
	54N15	Standard Gas Lens Cup 7/16"/11mm Bore
	54N14	Standard Gas Lens Cup 1/2"/13mm Bore
	54N19	Standard Gas Lens Cup 11/16"/17mm Bore

Long Gas Lens Cup

Stock Code Description

J	54N17L	Long Gas Lens Cup 5/16"/8mm Bore
	54N16L	Long Gas Lens Cup 3/8"/10mm Bore
	54N15L	Long Gas Lens Cup 7/16"/11mm Bore

Large Diameter Gas Lens Body

Stock Code Description

K	45V116	Large Dia Gas Lens Body 1/16"/1.6mm Bore
	45V64	Large Dia Gas Lens Body 3/32"/2.4mm Bore
	995795	Large Dia Gas Lens Body 1/8"/3.2mm Bore

Large Diameter Gas Lens Cup

Stock Code Description

L	57N75	Large Diameter Gas Lens Cup 3/8"/10mm Bore
	57N74	Large Diameter Gas Lens Cup 1/2"/15mm Bore
	53N88	Large Diameter Gas Lens Cup 5/8"/16mm Bore
	53N87	Large Diameter Gas Lens Cup 3/4"/19mm Bore

Components

Stock Code Description

1	18CG	Cup Gasket
2	18CG20	Cup Gasket for Stubby Collet Body
3	54N01	Gas Lens Insulator (use with 18CG)
4	54N63	Insulator Large Diameter Gas Lens (use with 18CG)
5	PRO26FX	Torch Head Flexible
6	PRO26	Torch Head including Cup Gasket
7	98W18	Back Cap O Ring
8	PRO57Y02	Back Cap Long
9	PRO57Y04	Back Cap Short
10	PRO1MS	Momentary Switch Kit (fitted as Standard) Alternative switch options are listed on Page 137
11	PROSWL4	Connector + Leads x 4mt/12.5ft
	PROSWL8	Connector + Leads x 8mt/25ft
12	PROH200	Pro-Grip™ Tig Handle Large
13	PROSP	Screw Pack
14	PROKJ200	Knuckle Joint c/w Lock Nut
15	PROLC200-08	Leather Cover x 0.8mt/2.6ft
16	PROCO200-40	Complete Cover Assembly x 4mt/12.5ft
	PROCO200-80	Complete Cover Assembly x 8mt/25ft
17	PRONCL-32	Neoprene Cover x 3.2mt/10.5ft
	PRONCL-72	Neoprene Cover x 7.2mt/23.6ft
18	PROJK200	Sheath Jointing Repair Kit